

# QUANTUM SR 3

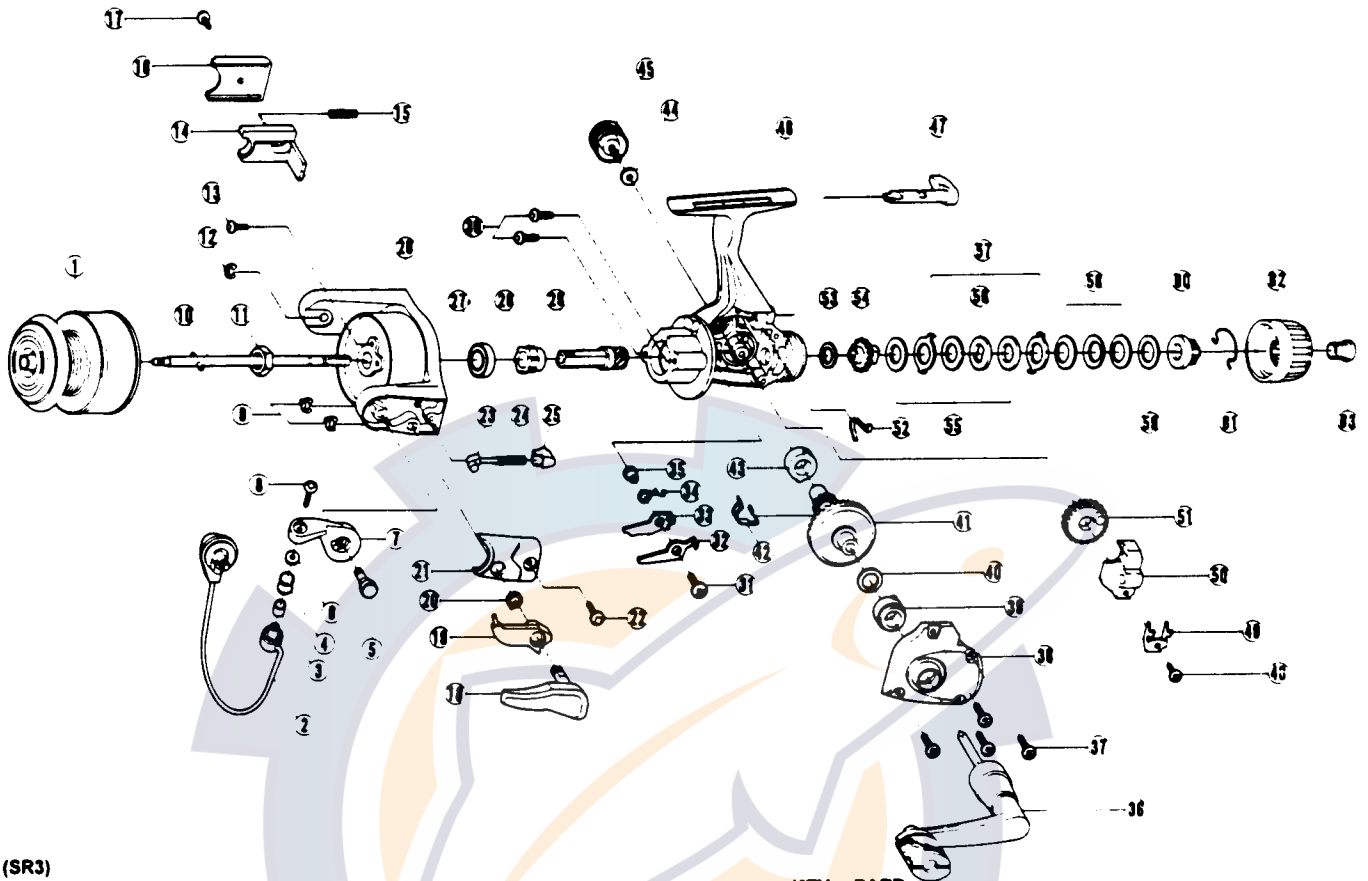

(SR3)

| KEY NO. | PART NO. | DESCRIPTION                | PRICE | KEY NO. | PART NO. | DESCRIPTION               | PRICE |
|---------|----------|----------------------------|-------|---------|----------|---------------------------|-------|
| 1       | JU321-18 | SPOOL ASSY.                | 10.15 | 33      | JU074-01 | ANTI-REVERSE PAWL 'B' ON  | .95   |
| 2       | GU347-03 | BAIL ASSY.                 | 4.30  | 34      | JU061-01 | ANTI-REVERSE PAWL SPRING  | 1.00  |
| 3       | MT016-02 | LINE ROLLER BUSHING        | .75   | 35      | GU091-02 | ANTI-REVERSE PAWL POST    | .70   |
| 4       | MT004-01 | LINE ROLLER                | 1.20  | 36      | GU318-23 | HANDLE ASSY.              | 5.15  |
| 5       | GU051-03 | ARM LEVER PIN              | 1.00  | 37      | GU057-01 | BODY COVER SCREW          | .15   |
| 6       | GU105-07 | LINE ROLLER WASHER         | .15   | 38      | JU023-07 | BODY COVER                | .235  |
| 7       | HU007-01 | ARM LEVER                  | 1.65  | 39      | JU027-01 | GEAR SHAFT BUSHING        | 1.55  |
| 8       | KQ108-01 | LINE SLIDER SCREW          | .30   | 40      | GU105-13 | ADJUSTMENT WASHER         | .62   |
| 9       | KQ034-01 | E-CLIP                     | .15   | 41      | JU012-01 | DRIVE GEAR                | 3.35  |
| 10      | JU315-01 | MAIN SHAFT ASSY.           | 1.75  | 42      | GU086-01 | SILENT CAM                | .40   |
| 11      | GU006-02 | ROTOR NUT                  | .80   | 43      | JU027-01 | GEAR SHAFT BUSHING        | 1.55  |
| 12      | KQ034-01 | E-CLIP                     | .15   | 44      | GU105-01 | HANDLE SCREW WASHER       | .10   |
| 13      | GU077-01 | ROTOR NUT LOCK SCREW       | .15   | 45      | GU073-01 | HANDLE SCREW              | .80   |
| 14      | JU019-01 | KICK LEVER                 | 1.00  | 46      | JU007-01 | BODY                      | 4.30  |
| 15      | KQ049-01 | KICK LEVER SPRING          | .25   | 47      | GU090-01 | ANTI-REVERSE LEVER        | 1.45  |
| 16      | JU046-01 | KICK LEVER COVER           | .75   | 48      | JU100-01 | OSCILLATOR RETAINER SCREW | .25   |
| 17      | GU077-02 | KICK LEVER COVER SCREW     | .15   | 49      | JU078-01 | OSCILLATOR SLIDE RETAINER | .30   |
| 18      | GU115-02 | TRIGGER ASSY.              | 3.50  | 50      | JU025-01 | OSCILLATOR SLIDER         | 1.75  |
| 19      | GU097-02 | TRIGGER LINK ASSY.         | 1.65  | 51      | JU053-01 | OSCILLATOR GEAR           | 1.75  |
| 20      | NL096-01 | TRIGGER SPRING             | .80   | 52      | GU089-01 | ANTI-REVERSE LEVER SPRING | .50   |
| 21      | JU087-01 | ARM LEVER SPRING COVER     | .65   | 53      | GU105-17 | DRAG FRICTION WSHR 'A'    | .77   |
| 22      | GU077-02 | ARM LEVER COVER SCREW      | .15   | 54      | JU075-01 | DRAG CLICK GEAR           | 1.25  |
| 23      | QL031-01 | ARM LEVER SPRING PIN       | .75   | 55      | GU105-18 | DRAG DISC                 | .88   |
| 24      | KQ049-02 | ARM LEVER SPRING           | .85   | 56      | JU080-01 | DRAG WASHER 'D'           | 1.00  |
| 25      | QL020-01 | ARM LEVER SPRING HOLDER    | .30   | 57      | JU081-01 | DRAG WASHER KEYED         | 1.00  |
| 26      | JU009-07 | ROTOR                      | 9.44  | 58      | JU043-01 | DRAG SPRING               | 1.30  |
| 27      | AQ028-06 | BALL BEARING               | 6.10  | 59      | GU105-19 | DRAG WASHER               | .93   |
| 28      | PL060-01 | ANTI-REVERSE RATCHET       | 2.00  | 60      | JU066-01 | DRAG NUT                  | 1.25  |
| 29      | JU011-01 | PINION GEAR                | 2.00  | 61      | JU083-01 | DRAG CLICK SPRING         | 1.85  |
| 30      | JU077-01 | BEARING SCREW              | .60   | 62      | JU032-01 | DRAG KNOB                 | 1.50  |
| 31      | GU077-05 | ANTI-REVERSE PAWL SCREW    | .15   | 63      | JU101-01 | DRAG KNOB SCREW           | 1.25  |
| 32      | GU063-01 | ANTI-REVERSE PAWL 'A' CNTR | .45   |         |          |                           |       |

Prices subject to change without notice. Prices do not include postage and handling.

**PLEASE ORDER BY PART NUMBER**

Rev. 6/94

Zebco Division Brunswick Corporation, Box 270, Tulsa, OK 74101 USA 918-836-5581

